

Powered Line Driver

Installation and user's guide

Date 12/2021 Rev. 05

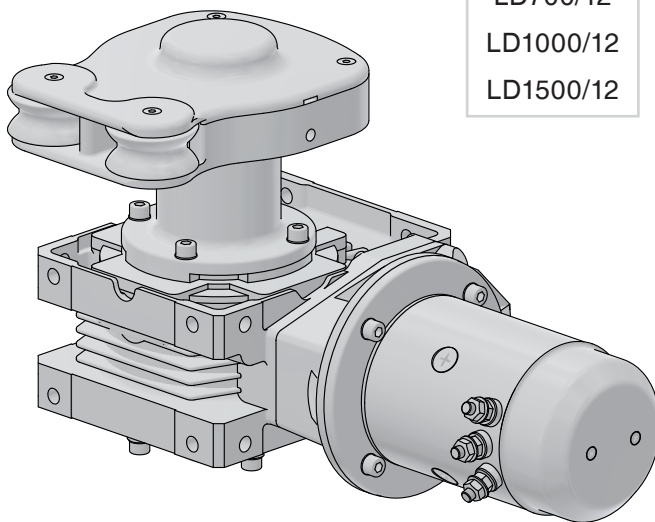

12 Volt

LD700/12

LD1000/12

LD1500/12

24 Volt

LD700/24

LD1000/24

LD1500/24

antal

Antal srl - Via del Progresso, 10 - 35127 Padova - Italy - www.antal.it

Tel. +39 049 8701265 / 8702655 - Fax: +39 049 760906 - antal@antal.it -

Contents

1. Table of overall dimension..... p. 3
2. Electric system p. 4
3. Installation..... p. 6
4. Exploded view p. 8
5. Force, absorption, speed diagram p.11

1. Table of overall dimension

Model	LD700
Ø Line (mm)	10 / 12
Weight (Kg)	15

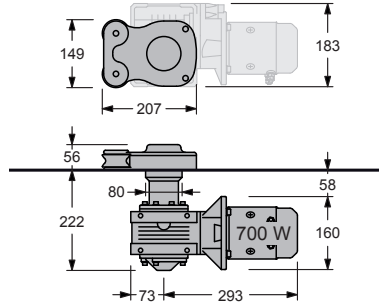

Model	LD1000
Ø Line (mm)	12 / 14
Weight (Kg)	20

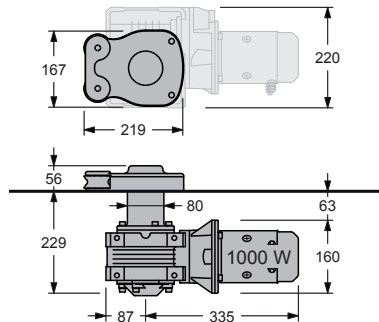

Model	LD1500
Ø Line (mm)	12 / 14
Weight (Kg)	22

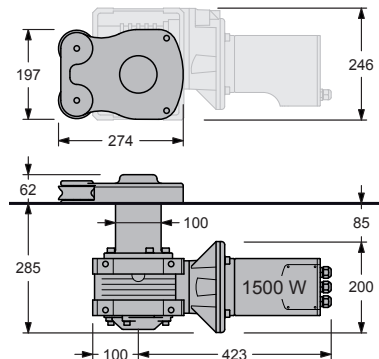

2. Electric system

2.1 Breaker

The thermal switches indicated in the following table have dimensions calculated to break the circuit in the case of exceptional overload; it is possible to consider thermal relays with a setting at a lower level.

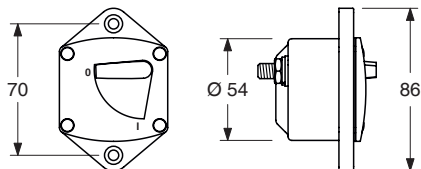

2.2 Control box

Contains the solenoids for activating the motor in button control operation.

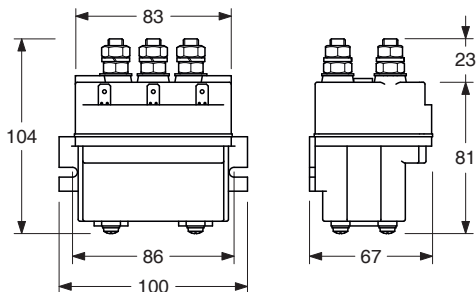

2.3 Switches

Two switches are needed to activate the movement in both directions.

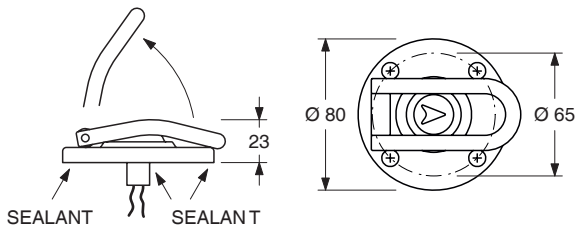

⚠ Although the microswitch is protected by a watertight diaphragm, the switch base is provided with a seat for sealant; more sealant must also be put in the hole through which the electric wire passes.

2.4 Circuit diagram

The electric system must be installed by specialised personnel, in compliance with the regulations in force; some general information is given below.

For the electric diagram directions included in the control box should be consulted.

- Red line | Electric diagram
- Blue line |
- Green line: end stop control system (optional)

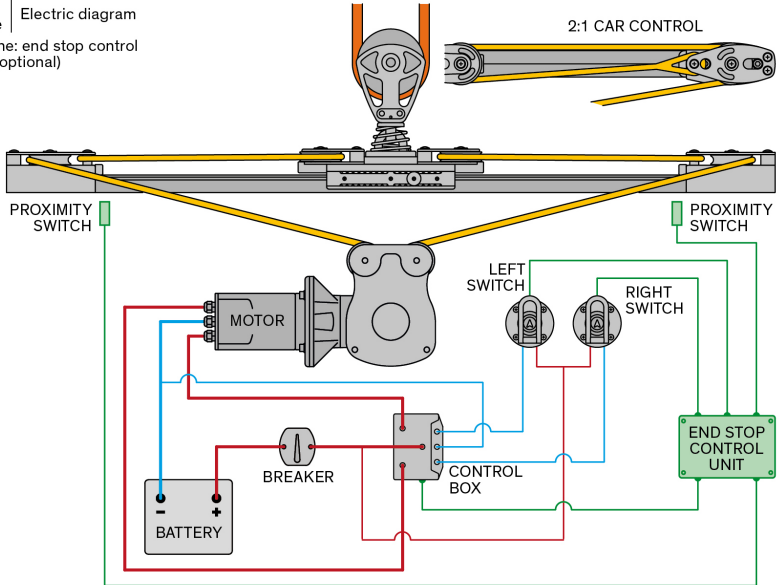

2.5 Power cables

The table lists suggested values for the cable sections; these values must be increased for very long systems or for prolonged use.

2.6 Button cables

Recommended section 1.5 to 2.5 mm².

2.7 Table of models

Model	Power		Cable mm ²	Breaker		Control Box Mod.
	Watt	Volt		Mod.	Amp	
LD700/12	700	12	30	A071	70	T6315/12
LD700/24		24	20	A041	40	T6315/24
LD1000/12	1000	12	35	A101	100	T6315/12
LD1000/24		24	25	A051	50	T6315/24
LD1500/12	1500	12	50	A151	150	T6315/12
LD1500/24		24	35	A071	70	T6315/24

3. Installation

3.1 Opening the Line Driver

Unscrew the 4 screws A and take off the cover B.

Unscrew the 2 screws L of the stripper M.

Take off the main sheave C and the stripper M (the main sheave and the stripper must be assembled/disassembled at the same time). To remove the sheave it is useful to screw 2 x Ø6 mm screws H (not included) into the threaded holes.

Unscrew the screws D and divide the motor unit F from the base E.

3.2 Fixing the Line Driver

After making a hole in the deck through which to pass the motor unit F, fix the base E to the deck with 4 screws N (not included) size 8 mm.

 Seal the holes for the anchoring screws and the join between the base and the deck with silicone.

Connect the motor unit F from under the deck to the base E with the screws D.

 Seal this join with silicone gasket (such as Motorsil Arexons).

Fit the motor unit F perfectly to the base E, then tight the screws D.

 **CAUTION** - The weight of the motor unit must be supported from below so as to distribute its tension correctly on the screws D; the uneven distribution of the unit's weight could cause it to tilt with respect to the base E, jeopardising perfect coupling and therefore the operation of the electric motor.

3.3 Line Insertion

After reassembling the main sheave C and the stripper M, insert the line before closing the cover B, it is easier to find the right line position with the cover open.

To insert the line it is necessary to turn the sheave C activating the motor.

The line insertion without the cover (cover open) must be done with the utmost care, because operating the line driver without the cover may be dangerous: avoid moving your hands or tools to the line driver while it is working.

Then close the cover B.

3.4 Lubrication

During assembly all the s.steel screws and washers must be generously greased to avoid corrosion phenomena in the areas in contact with aluminium parts. Antal supplies a special grease for marine applications: "Hidrolub" in 150 gr packs. This product is an excellent lubricant and ensures lasting protection of the aluminium against corrosion phenomena.

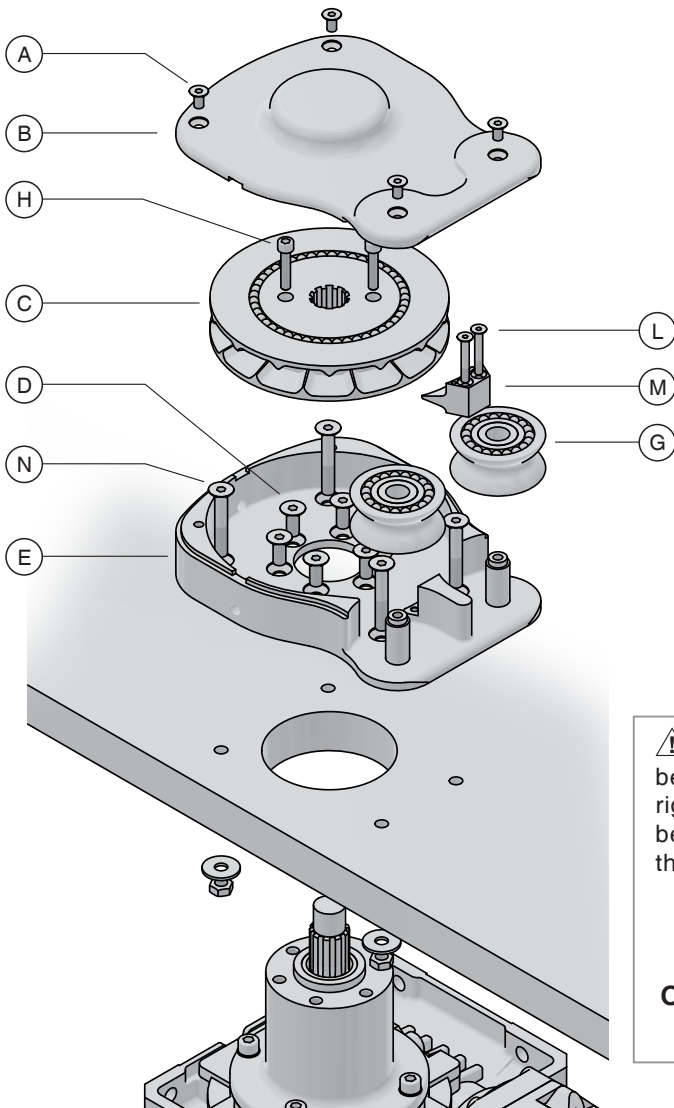

⚠ When you insert the rope be careful it goes to the right way, not getting stuck between the sheave C and the stripper M.

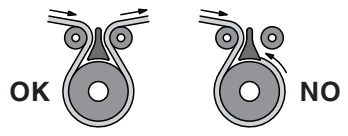

Warranty

Antal guarantees its equipment to be free of defects in material and workmanship for 3 years from the date of purchase. During this period defective parts will be repaired or replaced by Antal. Warranty does not cover: products incorrectly installed; products used in applications for which they are not intended; products used under loads exceeding the product's stated loads; products not properly maintained. Also, warranty does not cover defects due to corrosion, U-V degradation, and normal wear and tear.

Products subject to warranty claim will be returned to Antal for examination and possible repairing or replacement. Antal is not responsible for installation or shipping costs.

LD1000

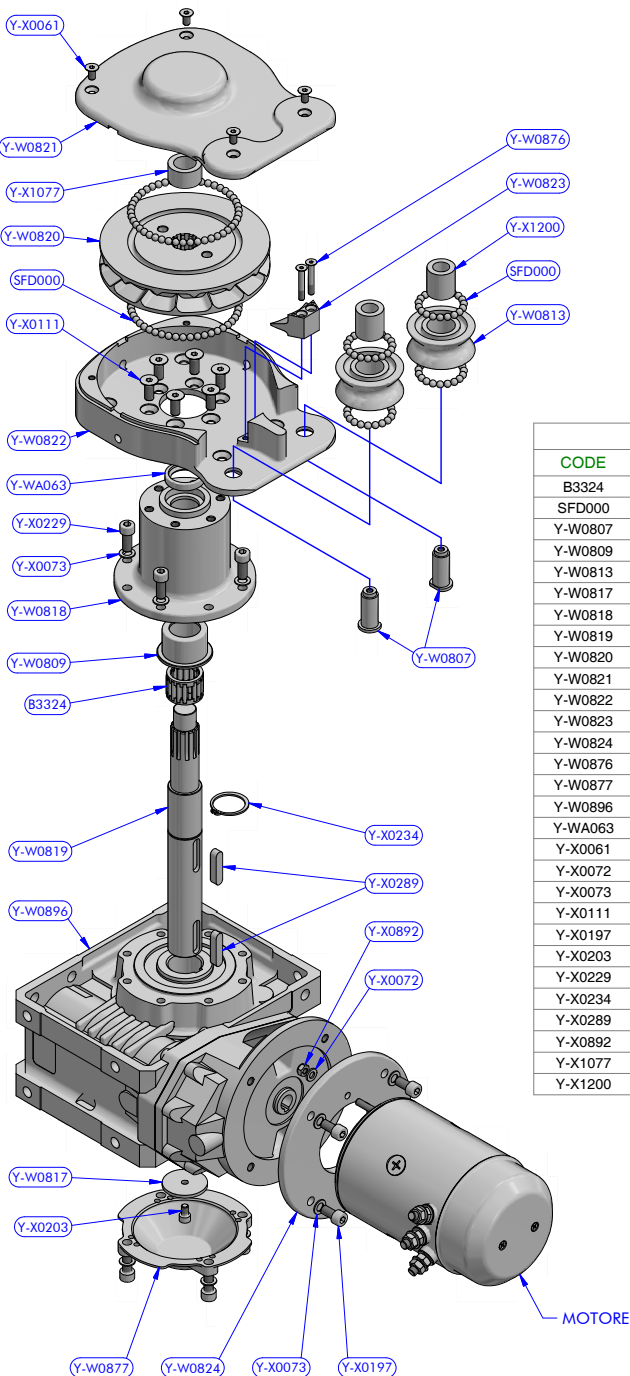

PART LIST

CODE	DESCRIPTION	MATERIAL	Q.TY
B3324	Roller bearing	Plastic / S.Steel	1
SFD000	Delrin ball 1/4"	Plastic	168
Y-W0807	Sheave spindle	S.Steel	2
Y-W0809	Bearing track	Plastic / S.Steel	1
Y-W0813	Tulip Sheave	Aluminium	2
Y-W0817	Washer	S.Steel	1
Y-W0818	Shaft box	Aluminium	1
Y-W0819	Main shaft	S.Steel HR	1
Y-W0820	Toothed sheave	Aluminium	1
Y-W0821	LD cover	Aluminium	1
Y-W0822	LD base	Aluminium	1
Y-W0823	Line guide	Mekton	1
Y-W0824	Motor flange	Aluminium	1
Y-W0876	Screw	S.Steel	2
Y-W0877	Gearbox cap	Plastic	1
Y-W0896	Gearbox	Various	1
Y-WA063	Shaft sealing ring	NBR rubber	1
Y-X0061	Screw	S.Steel	4
Y-X0072	Washer	S.Steel	2
Y-X0073	Washer	S.Steel	8
Y-X0111	Screw	S.Steel	6
Y-X0197	Screw	S.Steel	4
Y-X0203	Screw	S.Steel	1
Y-X0229	Screw	S.Steel	4
Y-X0234	Circlip (Seeger)	S.Steel	1
Y-X0289	Parallel key	S.Steel	2
Y-X0892	Nut	S.Steel	2
Y-X1077	C.F. main bushing	Composite Fibre	1
Y-X1200	Tulip bushing	Composite Fibre	2

MOTOR

CODE	VERSION	Q.TY
Y-W0418	1000 W - 12 V	1
Y-W0419	1000 W - 24 V	1

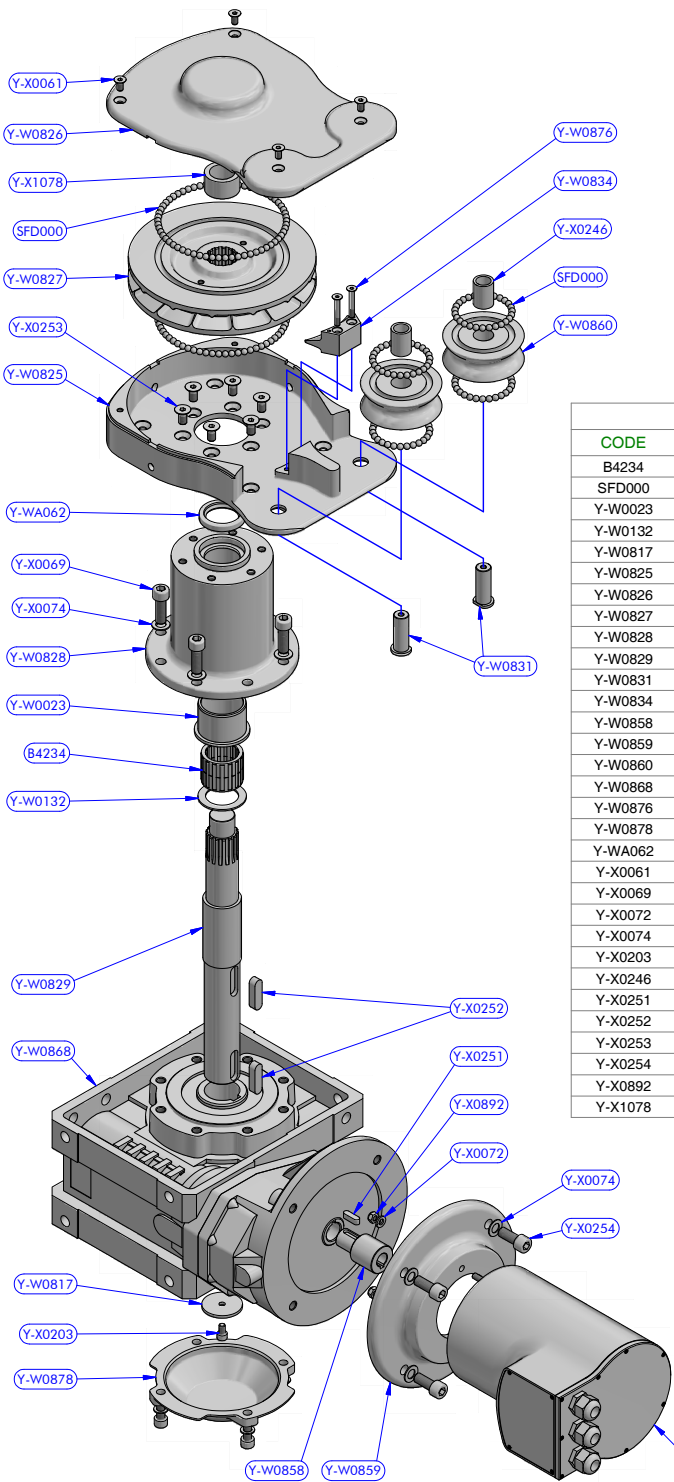

LD1500

PART LIST			
CODE	DESCRIPTION	MATERIAL	Q.TY
B4234	Roller bearing	Plastic / S.Steel	1
SFD000	Delrin ball 1/4"	Plastic	232
Y-W0023	Bearing track	Plastic / S.Steel	1
Y-W0132	Shaft washer	S.Steel	1
Y-W0817	Washer	S.Steel	1
Y-W0825	LD base	Aluminium	1
Y-W0826	LD cover	Aluminium	1
Y-W0827	Toothed sheave	Aluminium	1
Y-W0828	Shaft box	Aluminium	1
Y-W0829	Main shaft	S.Steel HR	1
Y-W0831	Sheave spindle	S.Steel	2
Y-W0834	Line guide	Mekton	1
Y-W0858	Shaft adapter	S.Steel	1
Y-W0859	Motor flange	Aluminium	1
Y-W0860	Tulip Sheave	Aluminium	2
Y-W0868	Gearbox	Various	1
Y-W0876	Screw	S.Steel	2
Y-W0878	Gearbox cap	Plastic	1
Y-WA062	Packing ring	NBR rubber	1
Y-X0061	Screw	S.Steel	4
Y-X0069	Screw	S.Steel	4
Y-X0072	Washer	S.Steel	2
Y-X0074	Washer	S.Steel	8
Y-X0203	Screw	S.Steel	1
Y-X0246	C.F. main bushing	Composite Fibre	2
Y-X0251	Parallel key	S.Steel	1
Y-X0252	Parallel key	S.Steel	2
Y-X0253	Screw	S.Steel	6
Y-X0254	Screw	S.Steel	4
Y-X0892	Nut	S.Steel	2
Y-X1078	C.F. main bushing	Composite Fibre	1

MOTOR		
CODE	VERSION	Q.TY
Y-W0420	1500 W - 12 V	1
Y-W0421	1500 W - 24 V	1

5. Force - Absorption - Speed diagram

