

antal

www.antal.it - antal@antal.it

Simple slider FB32 L100

DESCRIPTION

FB32.100S

MODEL CODE

1600 kg

SWL

0,41 kg

WEIGHT

14/03/2023

DATE

00

REV.

1 : 1

SCALE

This drawing is Antal's exclusive ownership, protected by law. Cannot be reproduced or handed over without preventive written consent.

Cod.Y-FA168
Base module

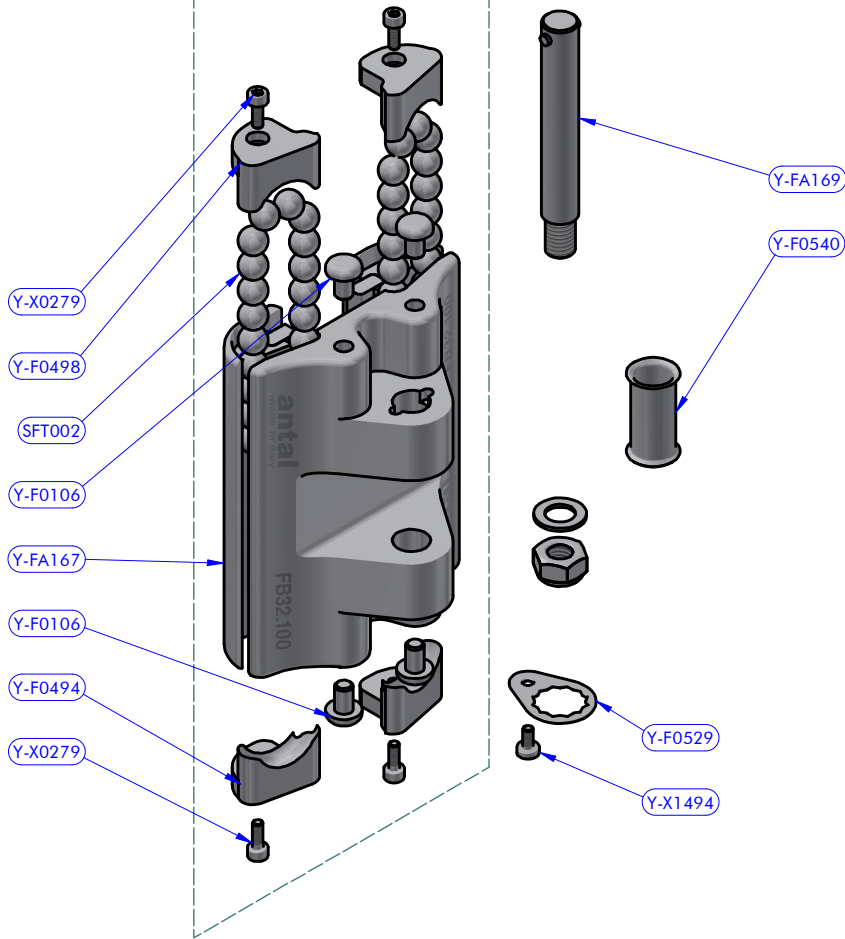

Cod.Y-FA167
Slider corps + Fibre guide

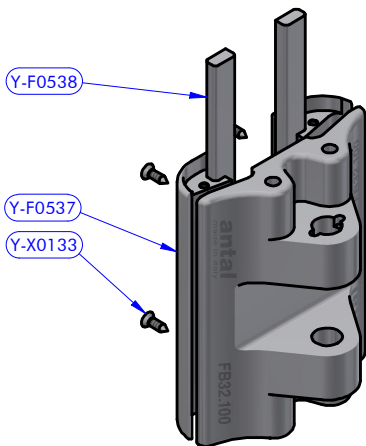

Cod.Y-FA169
Threaded pin kit

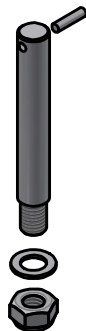

PART LIST

| CODE | DESCRIPTION | MATERIAL | Q.TY |
|---------|------------------|----------|------|
| Y-FA168 | Base module | Various | 1 |
| Y-F0540 | Bearing roller | S.Steel | 1 |
| Y-FA169 | Threaded pin kit | S.Steel | 1 |
| Y-F0529 | Exagonal washer | S.Steel | 1 |
| Y-X1494 | Screw | S.Steel | 1 |

PART LIST - Y-FA168

| CODE | DESCRIPTION | MATERIAL | Q.TY |
|---------|----------------------------|----------|------|
| Y-FA167 | Slider corps + Fibre guide | Various | 1 |
| Y-F0494 | Front cap | Plastic | 2 |
| Y-F0498 | Front cap | Plastic | 2 |
| Y-X0279 | Screw | S.Steel | 4 |
| Y-F0106 | Shockproof rubber | Rubber | 4 |
| SFT002 | Torlon ball | Torlon | 44 |

PART LIST - Y-FA167

| CODE | DESCRIPTION | MATERIAL | Q.TY |
|---------|--------------|-----------------|------|
| Y-F0537 | Slider corps | Aluminium | 1 |
| Y-F0538 | Fibre guide | Composite fibre | 2 |
| Y-X0133 | Screw | S.Steel | 4 |

antal

Simple slider FB32 L100

FB32.100S

14/03/2023

DATE

REV.

23031414

DWG N.

1 / 1

PG.

DESCRIPTION

MODEL CODE