

antal

www.antal.it - antal@antal.it

Slider with joint FB32 series L160 Pin
M14 x 28

DESCRIPTION

FB32.160J14

MODEL CODE

2500 kg

SWL

1.15

WEIGHT

11/03/2022

DATE

1 : 2

SCALE

This drawing is Antal's exclusive ownership, protected by law. Cannot be reproduced or handed over without preventive written consent.

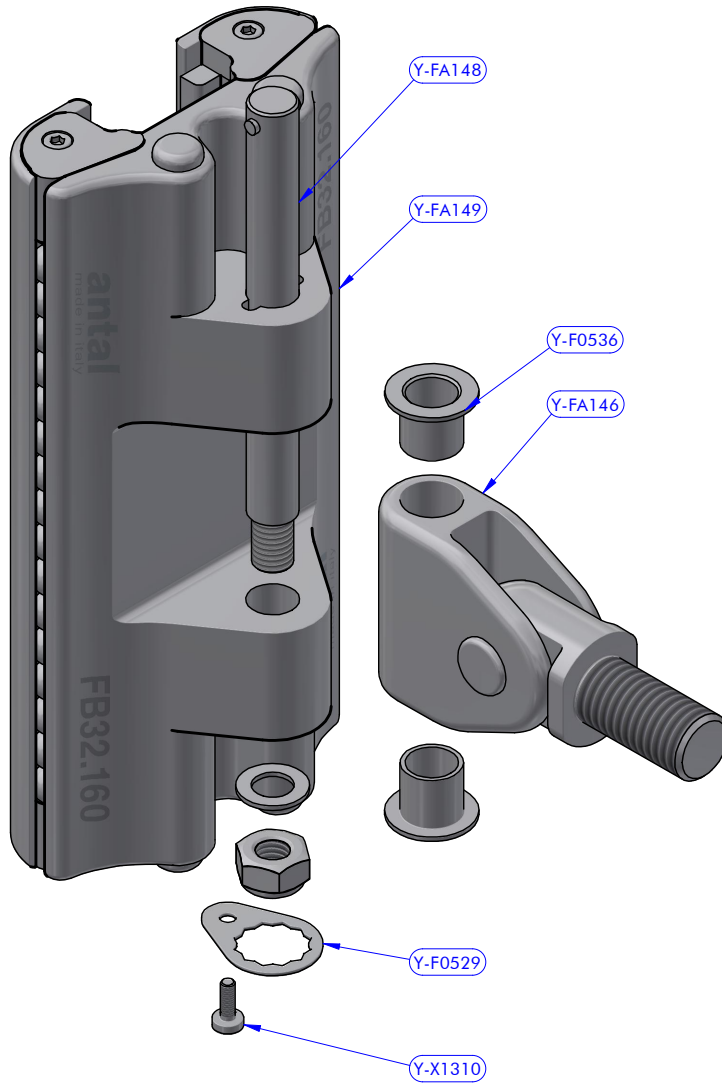

Cod.Y-FA149
Base module

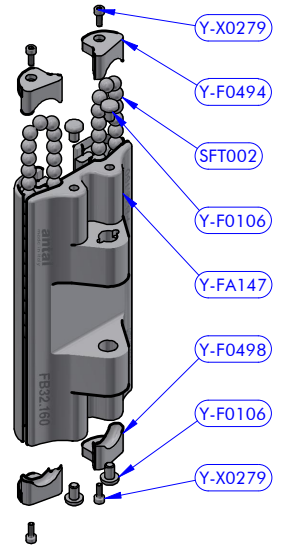

Cod.Y-FA148
Threaded pin kit



PART LIST			
CODE	DESCRIPTION	MATERIAL	Q.TY
Y-F0529	Exagonal washer	S.Steel	1
Y-F0536	Bushing	Chromed brass	2
Y-FA146	Triaxial joint	S.Steel	1
Y-FA148	Threaded pin kit	S.Steel	1
Y-FA149	Base module	Various	1
Y-X1310	Screw	S.Steel	1
PART LIST - Y-FA149			
CODE	DESCRIPTION	MATERIAL	Q.TY
SFT002	Torlon ball	Torlon	74
Y-F0106	Shockproof rubber	Rubber	4
Y-F0494	Front cap	Plastic	2
Y-F0498	Front cap	Plastic	2
Y-FA147	Slider corps + Fibre guide	Various	1
Y-X0279	Screw	S.Steel	4

antal

Slider with joint FB32 series L160 Pin
M14 x 28

FB32.160J14

11/03/2022

DATE REV.

22031140

DWG N. PG. /